



Circle, Square/Rectangle or Triangle

Digital Photography Group – fortnightly challenge

“Circle, Square/rectangle or Triangle”- up to 3 Photos

For our next meeting, I’m setting you a shape challenge to try. You can try enter 1, 2 or 3 photos.

However, please enter a maximum of 3 photos. So if you enter 3 different shapes, it would be 1 photo for each.

Please take up to 3 images of a subject which is circular, square/rectangle or a triangular shape. You can use colour or B&W. There can be other things in the image but the subject should be one of these shapes.

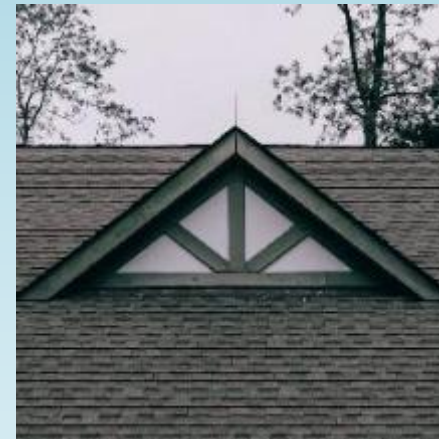

Please return your photos to John by **Sunday 1st February** to jsdpg2@gmail.com.

Please reduce the filesize of your images to 2Mb or less, or use WeTransfer <https://wetransfer.com/>

or PicDrop transfers <https://www.picdrop.com/web>

Barbara

Circle

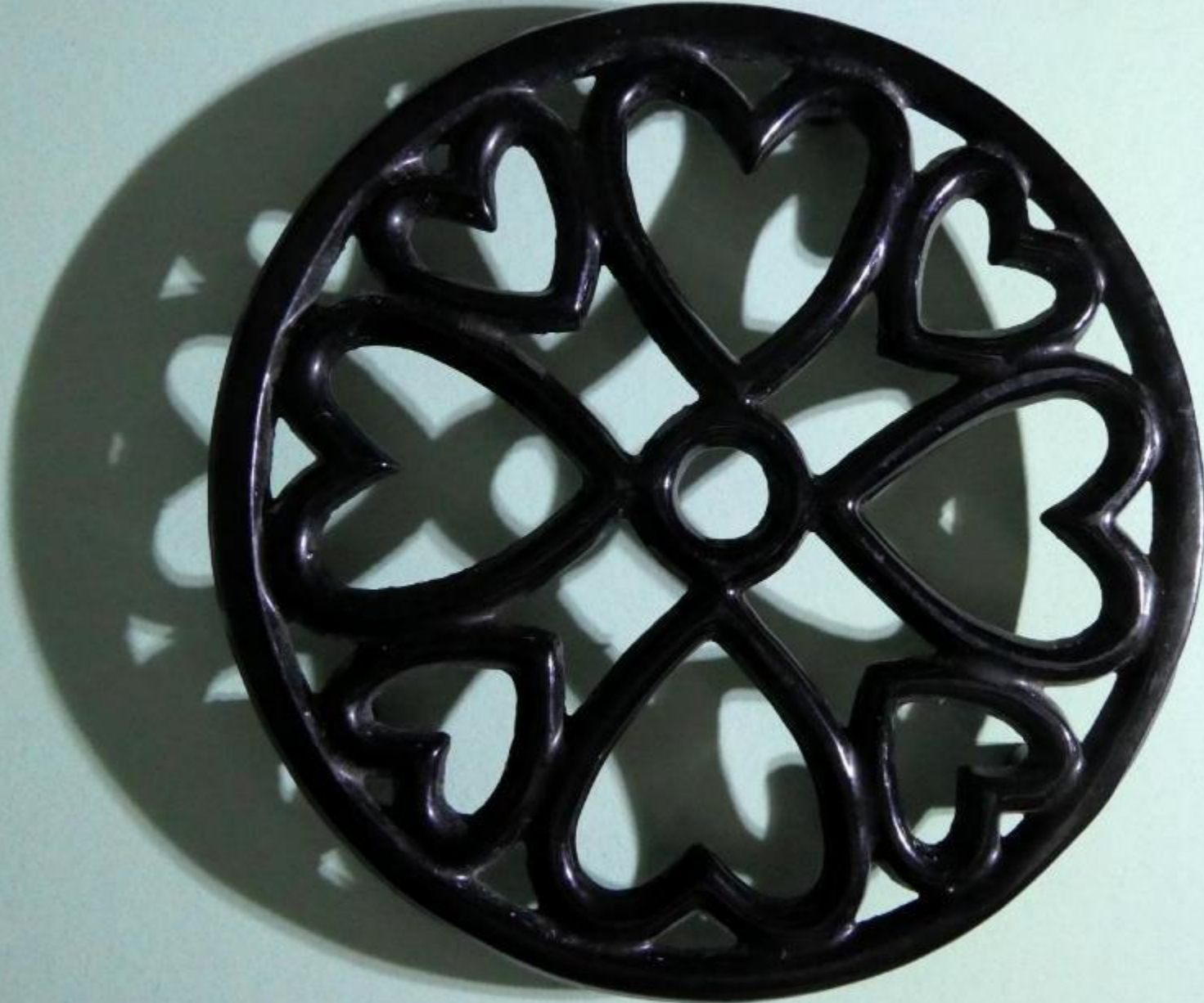

Squares



Triangle



Esme

Circle



Square



Triangle



Helen

Circle



Circle



Triangle



Howard

Triangle



Triangle



lan

Square



Triangle & circles !



Square & circle !



John

Circles



Squares



Triangle



Karen

Circles



Les

Circle



Square



Triangle



Liz

Circle & Squares !



Rectangles



Triangle



Pat

Circle



Square & circles !



Triangles

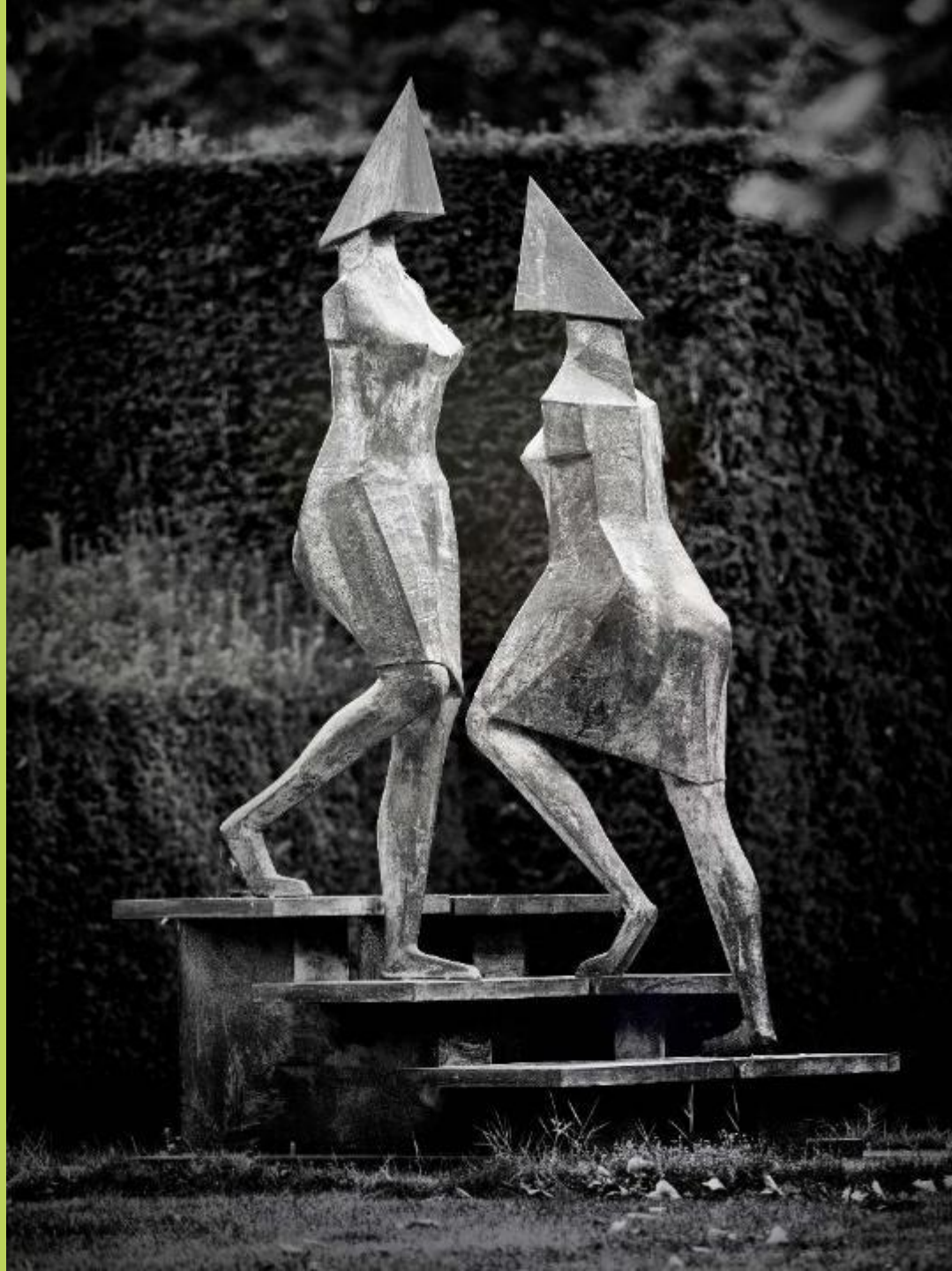

Sarah

Circle



Circle



Circle



**Kirkley Village
Shops**

Steve C

Circle



Square



Triangles



Steve M

Lots of shapes !



Rectangles



Triangle



Sue Bay

Squares



Triangle



Sue Bo

Circle



Triangle



Vince

Circle



Squares



Triangle

